

# MC 8P -

## Instructions for use





# Contents



<b>1</b>	<b>Safety instructions .....</b>	<b>2</b>
<b>2</b>	<b>Description.....</b>	<b>3</b>
2.1	Purpose .....	3
2.2	Operating elements .....	3
<b>3</b>	<b>Before starting the cleaner.....</b>	<b>3</b>
3.1	Setting up the cleaner .....	3
3.2	Connecting the high pressure hose (single user).....	4
3.3	Connecting the water supply .....	4
3.4	Electrical connection .....	5
3.5	Antifreeze - before first use .....	5
<b>4</b>	<b>Control / Operation.....</b>	<b>5</b>
4.1	Connecting the spray lance to the spray gun .....	5
4.2	Switching on the cleaner .....	5
4.3	Pressure regulation (Tornado Lance).....	6
4.4	Pressure regulation on the machine.....	6
<b>5</b>	<b>Applications and methods .....</b>	<b>6</b>
5.1	Techniques .....	6
5.2	Some typical cleaning tasks .....	7
<b>6</b>	<b>After using the cleaner .....</b>	<b>8</b>
6.1	Switching off the cleaner .....	8
6.2	Disconnecting supply lines .....	8
6.3	Rolling up the electrical lead and storing accessories.....	9
6.4	Storing the cleaner (below 0°C) .....	9
<b>7</b>	<b>Maintenance.....</b>	<b>10</b>
7.1	Maintenance plan .....	10
7.2	Maintenance work .....	10
<b>8</b>	<b>Troubleshooting .....</b>	<b>11</b>
<b>9</b>	<b>Further information .....</b>	<b>12</b>
9.1	Recycling the cleaner .....	12
9.2	Guarantee .....	12
9.3	EU Declaration of conformity.....	12
9.4	Technical Data.....	13



## Symbols used to mark instructions



Safety instructions in these operating instructions which must be observed to prevent risks to persons are marked with this danger symbol.



Before using the high-pressure cleaner, be sure to also read the enclosed operating instructions and keep them within reach at all times.



This indicates tips and instructions to simplify work and to ensure safe operation.



This symbol is used to mark safety instructions that must be observed to prevent damage to the machine and its performance.

# 1 Safety instructions

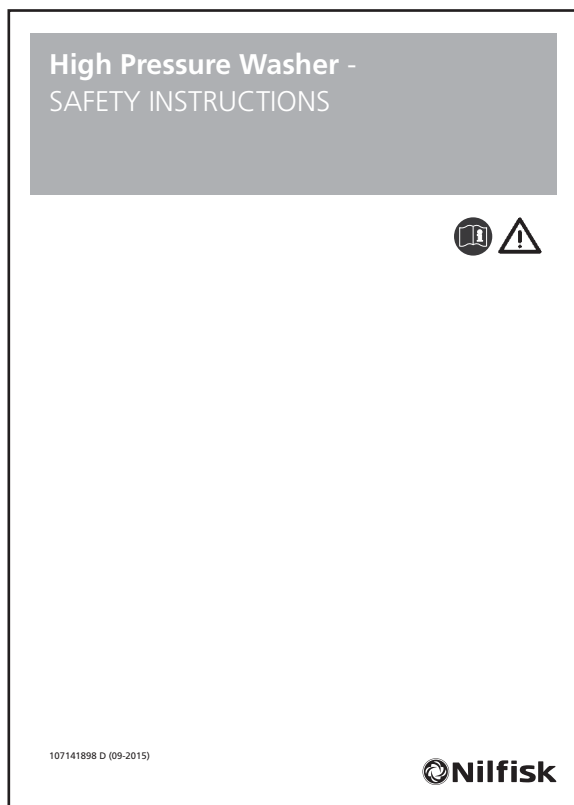

## 2 Description

### 2.1 Purpose

This high-pressure cleaner has been designed for professional use in

- Agriculture
  - industry
  - transport industry
  - automotive cleaning
  - municipal facilities
  - cleaning trade
  - construction industry
- etc.

Chapter 5 describes the use of the high-pressure cleaner for various cleaning jobs.

Always use the cleaner as described in these operating instructions. Any other use may damage the cleaner or the surface to be cleaned or may result in severe injury to persons.

### 2.2 Operating elements



See at front of these operating instructions.

- |                                      |   |
|--------------------------------------|---|
| 1 Handle                             | 6 Supply water connection with water inlet filter |
| 2 Spray gun                          | 7 Check pump oil level                            |
| 3 Receptacle for Spray lance         | 8 High pressure hose connection                   |
| 4 Pressure regulation on spray lance | 9 Pressure regulation                             |
| 5 Spray lance                        | 10 Pressure gauge                                 |
|                                      | 11 Main switch                                    |
|                                      | 12 Receptacle for electrical lead                 |

## 3 Before starting the cleaner

### 3.1 Setting up the cleaner

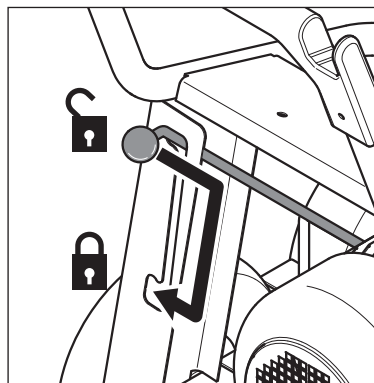

1. Before using the cleaner for the first time, check it carefully for any faults or damage.
2. Run the machine only when it is in perfect working condition.
3. Set the brake.

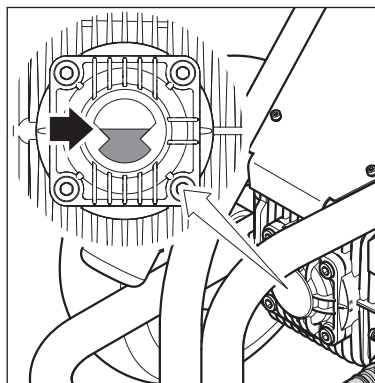

4. Check whether the oil level is between the minimum and maximum marks. If necessary, add oil (see chapter 9.4 for type of oil).

### 3.2 Connecting the high pressure hose (single user)

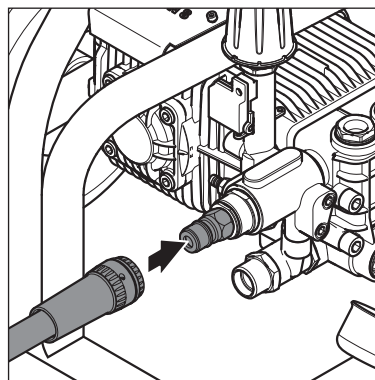

1. Put the quick connector of the high pressure hose onto the nipple on the cleaner.

#### 3.2.1 Connecting the high pressure hoses (2 users)

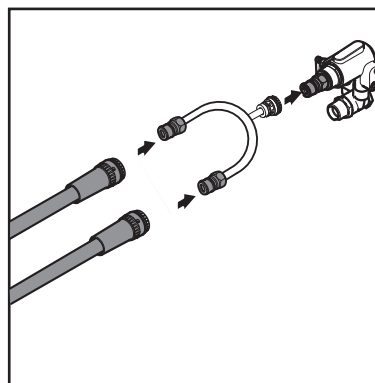

1. Put the quick connector of the distributor manifold onto the nipple of the high pressure washer
2. Put the quick connector of the high pressure hoses onto the nipples of the distributor manifold.



#### CAUTION!

In a 2 user system, the nozzle size is different from a single user system. It is necessary to change to the matching spray lances and a distributor manifold. (see chapter 9.4)

### 3.3 Connecting the water supply



See chapter 9.4 Technical Data for required quantity of water and water pressure.  
In the case of poor water quality (sand, etc.), we recommend that a fine water filter is fitted in the water inlet.

We recommend the use of a textile-reinforced water hose with a nominal diameter of min. 3/4" (19 mm).

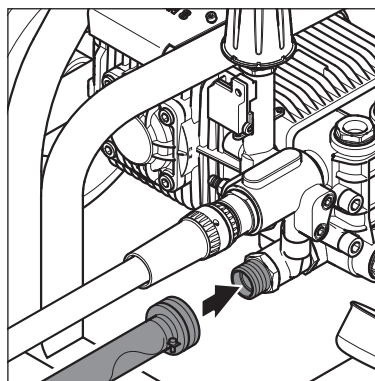

1. Rinse the water supply hose briefly in order to prevent sand and other dirt particles entering into the machine.
2. Connect water supply hose to the machine.
3. Open water tap.

### 3.4 Electrical connection



The cleaner may only be connected to a correctly installed electrical installation.

When using a cord reel:

1. Release brake of the cord reel.
2. Unwind the cord completely.

1. Observe safety instructions in chapter 1.
2. Put the plug into the electrical socket.



### 3.5 Antifreeze - before first use

The machine is protected with anti-freeze from the factory. Catch the liquid discharging at

first (approx. 1 l) for re-use in a container.

## 4 Control / Operation

### 4.1 Connecting the spray lance to the spray gun



Always remove any dirt from the nipple before connecting the spray lance to the spray gun.

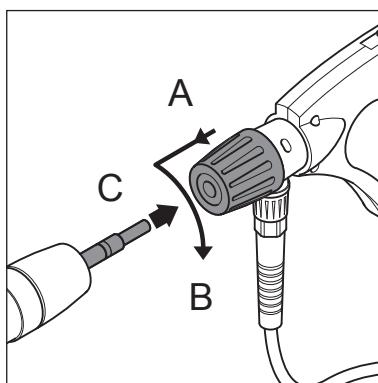

1. Pull the blue quick-release grip (A) of the spray gun forwards and lock it by turning it to the left.
2. Insert the nipple of the spray lance (C) into the quick-release connection and turn the blue quick-release grip to the right (B).
3. Pull the spray lance (or other accessory) forwards to check that it is securely attached to the spray gun.

### 4.2 Switching on the cleaner

#### 4.2.1 Switching on the cleaner when it is connected to a water supply



Operate the spray gun several times at short intervals to vent the system.

The cleaner switches off automatically after the spray gun has been closed. To start the cleaner again, operate the spray gun.

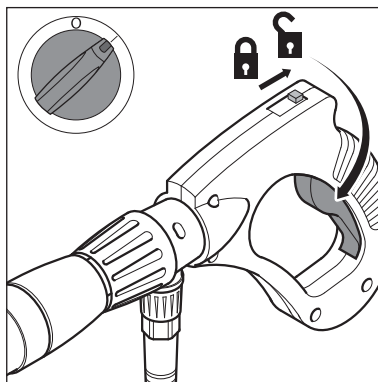

1. Main switch  
Turn the switch to position „I“.
2. Unlock the spray gun and operate it.
3. Lock the spray gun even during short pauses.

#### 4.2.2 Switching on the cleaner when it is connected to open tanks (suction mode)

1. Before connecting the suction hose to the cleaner, fill the hose with water. 2. Main switch  
Turn the switch to position „I“.
3. Unlock the spray gun and operate it.  
Max. suction height = 1.5 m.

#### 4.3 Pressure regulation (Tornado Lance)

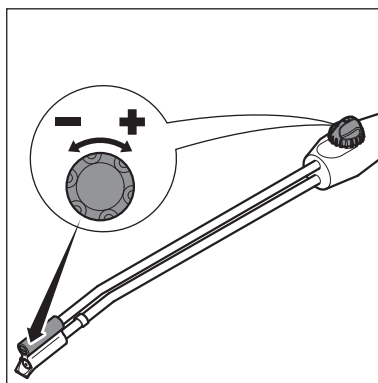

1. Turn the twist grip on the spray unit:

– **High pressure** = clockwise (+)

– **Low pressure** = anticlockwise (–)

#### 4.4 Pressure regulation on the machine

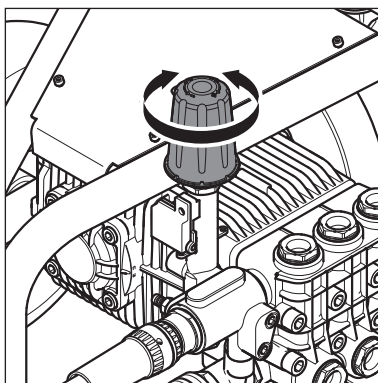

1. Set pressure and water volume by twisting the pressure/volume regulation knob on the machine.

## 5 Applications and methods

### 5.1 Techniques

Efficient high pressure cleaning is achieved by following a few guidelines, combined with your own personal experience of specific cleaning tasks. Accessories and detergents, when correctly chosen, can increase the efficiency of your pressure washer. Here is some basic information about cleaning.

#### 5.1.1 Soaking

Encrusted or thick layers of dirt can be loosened or softened up by a period of soaking. This is for example an ideal method within agriculture – for example, within pig sties. The ideal soaking method can be achieved via use of foam or simple alkaline detergent. Let the product lie on the dirty surfaces for around 30 minutes before pressure washing. The result will be a much quicker high pressure cleaning process.

#### 5.1.2 Detergent and Foam

Foam or detergent should be applied onto dry surfaces so that the chemical product is in direct contact with the dirt. Detergents are applied from bottom to top, for example on a car bodywork, in order to avoid “super clean” areas, where the detergent collects in higher concentration and streams downwards. Let the detergent work for several minutes before rinsing but never let it dry on the surface being cleaned.

#### 5.1.3 Temperature

Detergents are more effective at higher temperatures. Greases, oils and fats can be broken down more easily at higher temperatures also. Proteins can be cleaned at temperatures of around 60°C. Oils, traffic film around 70°C, and grease can be cleaned at 80°C - 90°C.



### 5.1.4 Mechanical Effect

In order to break down tough layers of dirt, additional mechanical effect may be required. Special lances and rotary or wash brushes offer this supplementary effect that cuts through dirt.

### 5.1.5 High Water Flow or High Pressure

High pressure is not always the best solution and high pressure may damage surfaces. The cleaning effect also depends upon water flow. Pressure levels of around 100 bar may be sufficient for vehicle cleaning (in association with hot water). Higher flow levels give the possibility to rinse and flush away large amounts of dirt easily.

## 5.2 Some typical cleaning tasks

### 5.2.1 Agriculture

Task	Accessories	Method
Stables Pig Pens, Sties  Cleaning of walls, floors and equipment  Disinfectant	Chemical Foam Injectors Foam lance Powerspeed lance Floor Cleaner  Detergents Universal Alkafoam  Disinfectant DES 3000	1. Soaking – apply foam to all surfaces (bottom to top) and wait for approx. 30 minutes. 2. Remove the dirt from surfaces with the high pressure lance or chosen accessory. Again, clean from bottom to top on vertical surfaces. 3. To flush away large quantities of dirt, change to low pressure mode and use the higher flow to push away the dirt. 4. Use recommended disinfectant products and methods to ensure hygiene. Apply DES 3000 disinfectant once the surfaces are perfectly clean.
Machinery Tractors ploughs etc.	Detergent injection Powerspeed lances Curved lances and underchassis washers Brushes	1. Apply detergent to vehicle or equipment surfaces in order to soften up dirt and grime. Apply from bottom to top. 2. Proceed with cleaning using the high pressure lance. Clean again from bottom to top. Use accessories to clean in difficult to reach places. 3. Clean fragile areas such as motors, rubber at lower pressure levels to avoid damage.

### 5.2.2 Vehicle

Task	Accessories	Method
Vehicle bodywork	Standard lance Detergent injection Curved lances and underchassis washers brushes  Detergents Aktive Shampoo Aktive Foam Sapphire Super Plus Aktive Wax Allosil RimTop	1. Apply detergent to vehicle or equipment surfaces in order to soften up dirt and grime. Apply from bottom to top. In cases of particularly dirty vehicles, pre-spray with a product such as Allosil in order to remove traces of insects etc, then rinse at low pressure and apply normal car cleaning detergent. Let detergents settle for 5 minutes before cleaning off. Metallic surfaces can be cleaned using RimTop. 2. Proceed with cleaning using the high pressure lance. Clean again from bottom to top. Use accessories to clean in difficult to reach places. Use brushes in order to add a mechanical cleaning effect. Short lances can help for cleaning of motors and wheel arches. Curved lances or undercarriage washers can be valuable for the cleaning of car underchassis and wheel arches. 3. Clean fragile areas such as motors, rubber at lower pressure levels to avoid damage. 4. Apply a liquid wax using the pressure washer in order to protect the bodywork from pollution.

## 5.2.3 Buildings and Equipment

Task	Accessories	Method
General surfaces Metallic equipment	Foam injectors Standard lance Curved lances Tank cleaning head  Detergents Intensive J25 Multi Combi Aktive Alkafoam  Disinfectant DES 3000	<ol style="list-style-type: none"> <li>1. Apply thick foam over the surfaces to be cleaned. Apply on dry surfaces. Apply from top to bottom on vertical surfaces. Let the foam act for up to 30 minutes for the optimal effect.</li> <li>2. Proceed with cleaning using the high pressure lance. Use applicable accessories. Use high pressure to dislodge large amounts of incrustated dirt or grime. Use lower pressure and high water volume in order to rapidly flush away loose dirt and rinse surfaces.</li> <li>3. Apply DES 3000 disinfectant once the surfaces are perfectly clean.</li> </ol> <p>Areas covered by amounts of loose dirt, such as animal remains in slaughterhouses, can be removed by using high water flow to flush away the dirt to evacuation pits or drains.</p> <p>Tank cleaning heads can be used to clean barrels, vats, mixing tanks etc. Cleaning heads may be hydraulically or electrically powered and give the possibility for automatic cleaning without a constant user.</p>
Rusted or damages surfaces prior to treatment	Wet Sandblasting equipment	<ol style="list-style-type: none"> <li>1. Connect the sandblasting lance to the pressure washer and place the suction tube in the sand.</li> <li>2. Always wear protective equipment during sandblasting.</li> <li>3. Spray the surfaces to be treated with the mix of water and sand. Rust, paint etc will be stripped off.</li> </ol>

These are merely several examples of cleaning tasks that can be solved by a pressure washer in association with accessories and detergents. Each cleaning task is different. Please consult your local dealer or Nilfisk representative in order to discuss the best solution for your own cleaning tasks.

# 6 After using the cleaner

## 6.1 Switching off the cleaner

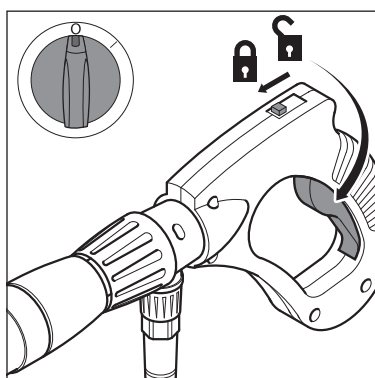

1. Turn the main switch to position „OFF“.
2. Close water tap.
3. Squeeze the spray gun handle until the cleaner is depressurised.
4. Lock the safety catch on the spray gun.

## 6.2 Disconnecting supply lines

1. Remove the water hose from the cleaner.
2. Pull out the plug from the electrical socket.

### 6.3 Rolling up the electrical lead and storing accessories

#### Risk of tripping!

To prevent accidents, always carefully roll up the electrical lead.



1. Wind up the high pressure hose.
2. Place the spray lance into the spray lance storage.

### 6.4 Storing the cleaner (below 0°C)



1. Store the cleaner in a dry room without danger of frost or protect as below:

#### CAUTION!

If the high-pressure cleaner is stored in a room with temperatures around or below 0°C, anti-freeze should be drawn into the pump beforehand:

1. Remove the water inlet hose from the cleaner.
2. Remove the spray lance.
3. Switch on the cleaner with the main switch in position „I“ and activate trigger on the spray gun.  
Switch off the cleaner after max. 3 minutes.
4. Connect the suction hose to the water inlet of the cleaner

and place it in a tank containing anti-freeze.

5. Switch on the cleaner with the main switch in position „I“.
6. Hold the spray gun over the tank containing anti-freeze and operate it to start suction.
7. During suction operate the spray gun two or three times.
8. Lift the suction hose from the tank containing anti-freeze and operate the spray gun to pump off the remaining anti-freeze.
9. Switching off the cleaner
10. To avoid any risks, store the cleaner temporarily in a heated room before using it again.

# 7 Maintenance

## 7.1 Maintenance plan

	Weekly	After the first 50 operating hours	Every six months or 500 operating hours	As required
7.2.1 Cleaning water inlet filter	●			●
7.2.2 Checking pump oil level	●			
7.2.3 Changing pump oil		●	●	

## 7.2 Maintenance work

### 7.2.1 Cleaning water inlet filter

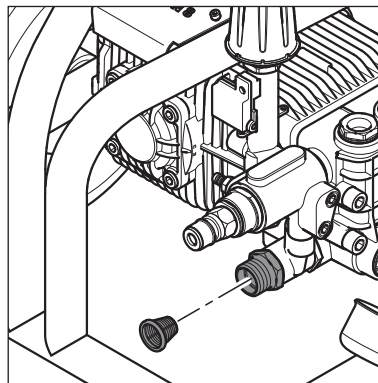

A water filter is fitted on the water inlet to prevent large particles of dirt from entering into the pump.

1. Unscrew the quick-release connection.
2. Remove the filter and rinse it. Replace damaged filter. Replace damaged filter.

### 7.2.2 Checking the pump oil level

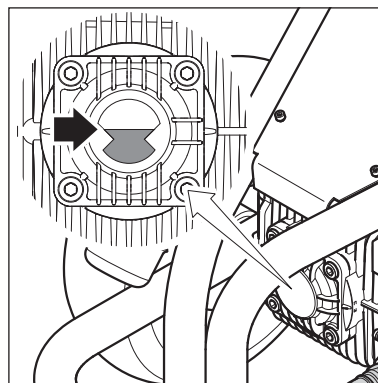

1. Check whether the oil level is between the minimum and maximum marks. If necessary, add oil (see chapter 9.4 for type of oil).

### 7.2.3 Changing the pump oil

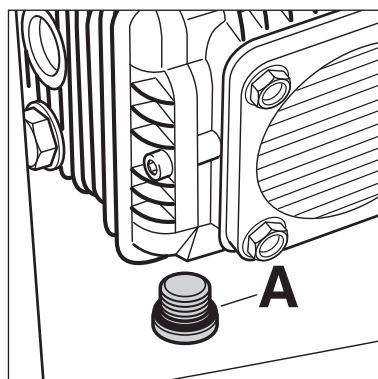

1. Unscrew the oil drain plug (A) and drain oil into a suitable container.
2. Check that the drain plug gasket is in place and reinstall drain plug.
3. Fill pump with proper grade and amount of oil. Oil grade and capacity see chapter '9.4 Technical Data'.

## 8 Troubleshooting

Fault	Cause	Remedy
Pressure drop	<ul style="list-style-type: none"> <li>&gt; Air in the system</li> <li>&gt; High pressure nozzle blocked worn</li> <li>&gt; Pressure control on the spray pipe is not set correctly</li> </ul>	<ul style="list-style-type: none"> <li>• Vent the system by operating the spray gun several times at short intervals. If necessary, operate the cleaner for a short time without the high-pressure hose connected.</li> <li>• Clean/replace the high pressure nozzle</li> <li>• Set the required working pressure</li> </ul>
Pressure fluctuations	<ul style="list-style-type: none"> <li>&gt; Pump draws in air (only possible in suction mode)</li> <li>&gt; Lack of water</li> <li>&gt; Water inlet hose is too long or its cross-section too small</li> <li>&gt; Lack of water caused by blocked water filter</li> <li>&gt; Lack of water because max. permissible suction height has not been heeded</li> </ul>	<ul style="list-style-type: none"> <li>• Check that the suction set is air-tight</li> <li>• Open water tap</li> <li>• Use specified water inlet hose</li> <li>• Clean the water filter in the water connection (never work without water filter)</li> <li>• See instructions</li> </ul>
The motor does not start when the cleaner is switched on	<ul style="list-style-type: none"> <li>&gt; The plug is not inserted properly, i.e. there is no current</li> <li>&gt; The mains fuse is switched off</li> </ul>	<ul style="list-style-type: none"> <li>• Check the plug, lead and switch and if necessary have them replaced by a trained electrician</li> <li>• Switch on the mains fuse</li> </ul>
When the cleaner is switched on the motor buzzes without starting	<ul style="list-style-type: none"> <li>&gt; The mains voltage is too low or there is a phase failure.</li> <li>&gt; The pump is blocked or frozen</li> <li>&gt; Incorrect cross-section or length of the extension lead</li> </ul>	<ul style="list-style-type: none"> <li>• Have the electrical connection checked</li> <li>• Contact the Nilfisk customer service</li> <li>• Use lead with correct cross section or length</li> </ul>
The motor switches off	<ul style="list-style-type: none"> <li>&gt; The overload protection has been activated due to overheating or overloading of the motor</li> <li>&gt; High-pressure nozzle is dirty</li> </ul>	<ul style="list-style-type: none"> <li>• Check that the mains voltage and the cleaner voltage are the same. Switch off the cleaner and allow it to cool for at least 3 minutes</li> <li>• Change the high-pressure nozzle</li> </ul>

## 9 Further information

### 9.1 Recycling the cleaner



Make the old cleaner unusable immediately.

1. Unplug the cleaner and cut the power cord.

Do not discard of electrical appliances with household waste.

As specified in European Directive 2012/19/EU on old electrical and electronic appliances, used electrical goods must be collected separately and recycled ecologically. Contact your local authorities or your nearest dealer for further information.

### 9.2 Guarantee

Our general conditions of business are applicable with regard to the guarantee. Subject to

change as a result of technical advances.

### 9.3 EU Declaration of conformity

We,  
Nilfisk A/S  
Kornmarksvej 1  
DK-2605 Broendby  
DENMARK

Hereby solely declare, that the product:

HPW - Professional - Mobile  
Description 230/1/50, 400/3/50, IPX5  
Type MC 8P-\*/\*

Are in compliance with the following standards:

EN 60335-1:2012+A11:2014  
EN 60335-2-79:2012  
EN 55014-1:2006+A1:2009+A2:2011  
EN 55014-2:1997+A1:2001+A2:2008  
EN 61000-3-2:2014  
EN 61000-3-11:2000  
EN 50581:2012

Following the provisions of:

Machinery Directive 2006/42/EC  
EMC Directive 2004/108/EC  
RoHS Directive 2011/65/EC  
Noise Emission Directive 2000/14/EC – Conformity assessment procedure according to Annex V.

- Measured noise level [dB]: 83-93  
- Guaranteed noise level [dB]: 86-94

Hadsund 02-10-2015

Anton Sørensen  
Senior Vice President – Global R&D

## 9.4 Technical Data



MC		8P-180/2100	8P-160/2500 8P-160/2500 ST
Voltage 400 V / 3~ / 50 Hz		EU	EU
Fuse (slow)	A	24	24.9
Power rating	kW	14	14.5
Working pressure	bar (Mpa)	180 (18)	160 (16)
Volume flow Q <sub>max</sub>	l/h	2100	2500
Water volume Q <sub>IEC</sub>	l/h	2050	2450
Max. water inlet temperature	°C/°F	60/86	60/86
Max. water inlet pressure	bar (Mpa)	10 (1)	10 (1)
Dimensions l x w x h	mm	897 x 652 x 913	897 x 652 x 913
Weight of cleaner	kg	130	130
Noise level at a distance of 1m EN 60704-1	dB(A)	79.2	81.6
Sound power level LW <sub>A</sub>	dB(A)	95/93.1	95.4
Vibration ISO 5349	m/s <sup>2</sup>	≤ 2,5	≤ 2,5
Recoil forces	N	106	124
Oil quantity	l	1	1
Oil type		SAE 15 W 40	SAE 15 W 40
Nozzle size (1 user)		1200	1590
Nozzle size (2 users)		0.600/0.600	0.800/0.800





## HEAD QUARTER

### DENMARK

Nilfisk A/S  
Kornmarksvej 1  
DK-2605 Brøndby  
Tel.: (+45) 4323 8100  
www.nilfisk.com

## SALES COMPANIES

### ARGENTINA

Nilfisk srl.  
Edificio Central Park  
Herrera 1855, 6th floor/604  
Ciudad de Buenos Aires  
Tel.: (+54) 11 6091 1571  
www.nilfisk.com.ar

### AUSTRALIA

Nilfisk Pty Ltd  
Unit 1/13 Bessemer Street  
Blacktown NSW 2148  
Tel.: (+61) 2 98348100  
www.nilfisk.com.au

### AUSTRIA

Nilfisk GmbH  
Metzgerstrasse 68  
5101 Bergheim bei Salzburg  
Tel.: (+43) 662 456 400 90  
www.nilfisk.at

### BELGIUM

Nilfisk n.v.-s.a.  
Riverside Business Park  
Boulevard Internationalelaan 55  
Bâtiment C3/C4 Gebouw  
Bruxelles 1070  
Tel.: (+32) 14 67 60 50  
www.nilfisk.be

### BRAZIL

Nilfisk do Brasil  
Av. Eng. Luis Carlos Berrini, 550  
40 Andar, Sala 03  
SP - 04571-000 Sao Paulo  
Tel.: (+11) 3959-0300 / 3945-4744  
www.nilfisk.com.br

### CANADA

Nilfisk Canada Company  
240 Superior Boulevard  
Mississauga, Ontario L5T 2L2  
Tel.: (+1) 800-668-8400  
www.nilfisk.ca

### CHILE

Nilfisk S.A. (Comercial KCS Ltda)  
Salar de Llamara 822  
8320000 Santiago  
Tel.: (+56) 2684 5000  
www.nilfisk.cl

### CHINA

Nilfisk  
4189 Yindu Road  
Xinzhuang Industrial Park  
201108 Shanghai  
Tel.: (+86) 21 3323 2000  
www.nilfisk.cn

### CZECH REPUBLIC

Nilfisk s.r.o.  
VGP Park Horní Počernice  
Do Čertous 1/2658  
193 00 Praha 9  
Tel.: (+420) 244 090 912  
www.nilfisk.cz

### DENMARK

Nilfisk Danmark A/S  
Industrivej 1  
Hadsund, DK-9560  
Tel.: 72 18 21 20  
www.nilfisk.dk

### FINLAND

Nilfisk Oy Ab  
Koskelontie 23 E  
02920 Espoo  
Tel.: (+358) 207 890 600  
www.nilfisk.fi

### FRANCE

Nilfisk SAS  
26 Avenue de la Baltique  
Villebon sur Yvette  
91978 Courtabouef Cedex  
Tel.: (+33) 169 59 87 00  
www.nilfisk.fr

### GERMANY

Nilfisk GmbH  
Guido-Oberdorfer-Straße 2-10  
89287 Bellenberg  
Tel.: (+49) (0)7306/72-444  
www.nilfisk.de

### GREECE

Nilfisk A.E.  
Αναπαύσεως 29  
Κορωπύ Τ.Κ. 194 00  
Tel.: (30) 210 9119 600  
www.nilfisk.gr

### HOLLAND

Nilfisk B.V.  
Versterkerstraat 5  
1322 AN Almere  
Tel.: (+31) 036 5460760  
www.nilfisk.nl

### HONG KONG

Nilfisk Ltd.  
2001 HK Worsted Mills  
Industrial Building  
31-39, Wo Tong Tsui St.  
Kwai Chung, N.T.  
Tel.: (+852) 2427 5951  
www.nilfisk.com

### HUNGARY

Nilfisk Kft.  
II. Rákóczi Ferenc út 10  
2310 Szigetszentmiklós-Lakihegy  
Tel.: (+36) 24 475 550  
www.nilfisk.hu

### INDIA

Nilfisk India Limited  
Pramukh Plaza, 'B' Wing, 4th floor, Unit  
No. 403  
Cardinal Gracious Road, Chakala  
Andheri (East) Mumbai 400 099  
Tel.: (+91) 22 6118 8188  
www.nilfisk.in

### IRELAND

Nilfisk  
1 Stokes Place  
St. Stephen's Green  
Dublin 2  
Tel.: (+35) 3 12 94 38 38  
www.nilfisk.ie

### ITALY

Nilfisk SpA  
Strada Comunale della Braglia, 18  
26862 Guardamiglio (LO)  
Tel.: (+39) (0) 377 414021  
www.nilfisk.it

### JAPAN

Nilfisk Inc.  
1-6-6 Kita-shinyokohama, Kouhoku-ku  
Yokohama, 223-0059  
Tel.: (+81) 45548 2571  
www.nilfisk.com

### MALAYSIA

Nilfisk Sdn Bhd  
Sd 33, Jalan KIP 10  
Taman Perindustrian KIP  
Sri Damansara  
52200 Kuala Lumpur  
Tel.: (60) 3603 627 43 120  
www.nilfisk.com

### MEXICO

Nilfisk de Mexico, S. de R.L. de C.V.  
Pirineos #515 Int.  
60-70 Microparque  
Industrial WSantiago  
76120 Queretaro  
Tel.: (+52) (442) 427 77 00  
www.nilfisk.com

### NEW ZEALAND

Nilfisk Limited  
Danish House  
6 Rockridge Avenue  
Penrose, Auckland 1061  
Tel.: (+64) 9526 3890  
www.nilfisk.com.au

### NORWAY

Nilfisk AS  
Bjørnerudveien 24  
1266 Oslo  
Tel.: (+47) 22 75 17 80  
www.nilfisk.no

### PERU

Nilfisk S.A.C.  
Calle Boulevard 162, Of. 703, Lima 33-  
Perú  
Lima  
Tel.: (511) 435-6840  
www.nilfisk.com

### POLAND

Nilfisk Sp. Z.O.O.  
Millenium Logistic Park  
ul. 3 Maja 8, Bud. B4  
05-800 Pruszków  
Tel.: (+48) 22 738 3750  
www.nilfisk.pl

### PORTUGAL

Nilfisk Lda.  
Sintra Business Park  
Zona Industrial Da Abrunheira  
Edificio 1, 1º A  
P2710-089 Sintra  
Tel.: (+351) 21 911 2670  
www.nilfisk.pt

### RUSSIA

Nilfisk LLC  
Vyatskaya str. 27, bld. 7/1st  
127015 Moscow  
Tel.: (+7) 495 783 9602  
www.nilfisk.ru

### SINGAPORE

Den-Sin  
22 Tuas Avenue 2  
639453 Singapore  
Tel.: (+65) 6268 1006  
www.densin.com

### SLOVAKIA

Nilfisk s.r.o.  
Bancikovej 1/A  
SK-821 03 Bratislava  
Tel.: (+421) 910 222 928  
www.nilfisk.sk

### SOUTH AFRICA

WAP South Africa  
12 Newton Street  
Spartan 1630  
Tel.: (+27) 11 975 7060  
www.wap.com.za

### SOUTH KOREA

Nilfisk Korea  
3F Duksoo B/D, 317-15  
Sungsoo-Dong 2Ga  
Sungdong-Gu, Seoul  
Tel.: (+82) 2497 8636  
www.nilfisk.co.kr

### SPAIN

Nilfisk S.A.  
Torre d'Ara,  
Passeig del Rengle, 5 Plta. 10ª  
08302 Mataró  
Tel.: (34) 93 741 2400  
www.nilfisk.es

### SWEDEN

Nilfisk AB  
Taljegårdsgatan 4  
431 53 Mölndal  
Tel.: (+46) 31 706 73 00  
www.nilfisk.se

### SWITZERLAND

Nilfisk AG  
Ringstrasse 19  
Kircheberg/Industri Stelz  
9500 Wil  
Tel.: (+41) 71 92 38 444  
www.nilfisk.ch

### TAIWAN

Nilfisk Ltd  
Taiwan Branch (H.K)  
No. 5, Wan Fang Road  
Taipei  
Tel.: (+88) 6227 00 22 68  
www.nilfisk.tw

### THAILAND

Nilfisk Co. Ltd.  
89 Soi Chokechai-Ruammitr  
Viphavadee-Rangsit Road  
Ladyao, Jatuchak, Bangkok 10900  
Tel.: (+66) 2275 5630  
www.nilfisk.co.th

### TURKEY

Nilfisk A.S.  
Serifali Mh. Bayraktar Bulv. Sehit Sk. No:7  
Ümraniye, 34775 Istanbul  
Tel.: +90 216 466 94 94  
www.nilfisk.com.tr

### UNITED ARAB EMIRATES

Nilfisk Middle East Branch  
SAIF-Zone  
P.O. Box 122298  
Sharjah  
Tel.: (+971) (0) 655-78813  
www.nilfisk.com

### UNITED KINGDOM

Nilfisk Ltd.  
Nilfisk House, Bowerbank Way  
Gilwilly Industrial Estate, Penrith  
Cumbria CA11 9BQ  
Tel.: (+44) (0) 1768 868995  
www.nilfisk.co.uk

### UNITED STATES

Nilfisk Inc.  
14600 21st Avenue North  
Plymouth, MN-55447  
Tel.: (+1) 800-989-2235  
www.nilfisk.com

### VIETNAM

Nilfisk Vietnam  
No. 51 Doc Ngu Str.  
P. Vinh Phúc, Q.Ba Dinh  
Hanoi  
Tel.: (+84) 761 5642  
www.nilfisk.com

